

921.182.34.029 / 921.182.34.079

### Specifications:

- Non-handed CE Certified Commercial Mortise Architectural Cylinder Operated Nightlatch Lock
- Dimensions follow the requirements of **DIN 18251** & conforms to **EN12209:2003**
- Suitable for use on fire doors.
- Reversible latch bolt allows installation on either left or right handed doors.
- Applicable to both wood & metal doors.
- Available in sash lock, latch lock, bathroom (WC) lock and deadbolt functions.
- Available with 20 or 24 mm stainless steel

### Specifications:

- Backset 55 / 60 mm
- Spindle follower to cylinder centre 72/85mm
- 63 mm wc / bathroom
- 8 mm square follower 30 degree cam

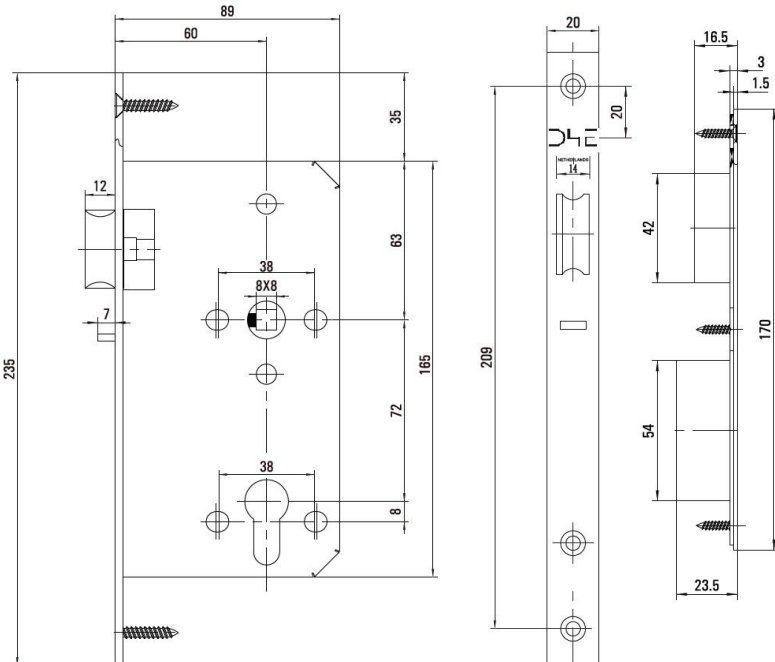

product classification:

3	X	8	1*	0	G	3	B	C	2	0
---	---	---	----	---	---	---	---	---	---	---

